

SI-15-00001  
Counce

4/13/2015

Area  
Map

kaycee.hathaway

# Critical Areas Checklist

Monday, April 13, 2015

Application File Number



Planner

Is SEPA required  Yes  No



Is Parcel History required?  Yes  No

What is the Zoning?



Is Project inside a Fire District?  Yes  No

If so, which one?



Is the project inside an Irrigation District?  Yes  No

If so, which one?

Does project have Irrigation Approval?  Yes  No

Which School District?

Is the project inside a UGA?  Yes  No

If so which one?

Is there FIRM floodplain on the project's parcel?  Yes  No

If so which zone?

What is the FIRM Panel Number?

Is the Project parcel in the Floodway?  Yes  No

Does the project parcel contain a shoreline of the State?  Yes  No

If so what is the Water Body?

What is the designation?

Does the project parcel contain a Classified Stream?  Yes  No

If so what is the Classification?

Does the project parcel contain a wetland?  Yes  No

If so what type is it?

Does the project parcel intersect a PHS designation?  Yes  No

If so, what is the Site Name?

Is there hazardous slope in the project parcel?  Yes  No

If so, what type?

Does the project parcel abut a DOT road?  Yes  No

If so, which one?

Does the project parcel abut a Forest Service road?  Yes  No

If so, which one?

Does the project parcel intersect an Airport overlay zone ?  Yes  No

If so, which Zone is it in?

Does the project parcel intersect a BPA right of way or line?  Yes  No

If so, which one?

Is the project parcel in or near a Mineral Resource Land?  Yes  No

If so, which one?

Is the project parcel in or near a DNR Landslide area?  Yes  No

If so, which one?

Is the project parcel in or near a Coal Mine area?  Yes  No

What is the Seismic Designation?

Does the Project Application have a Title Report Attached?

Does the Project Application have a Recorded Survey Attached?

Have the Current Years Taxes been paid?

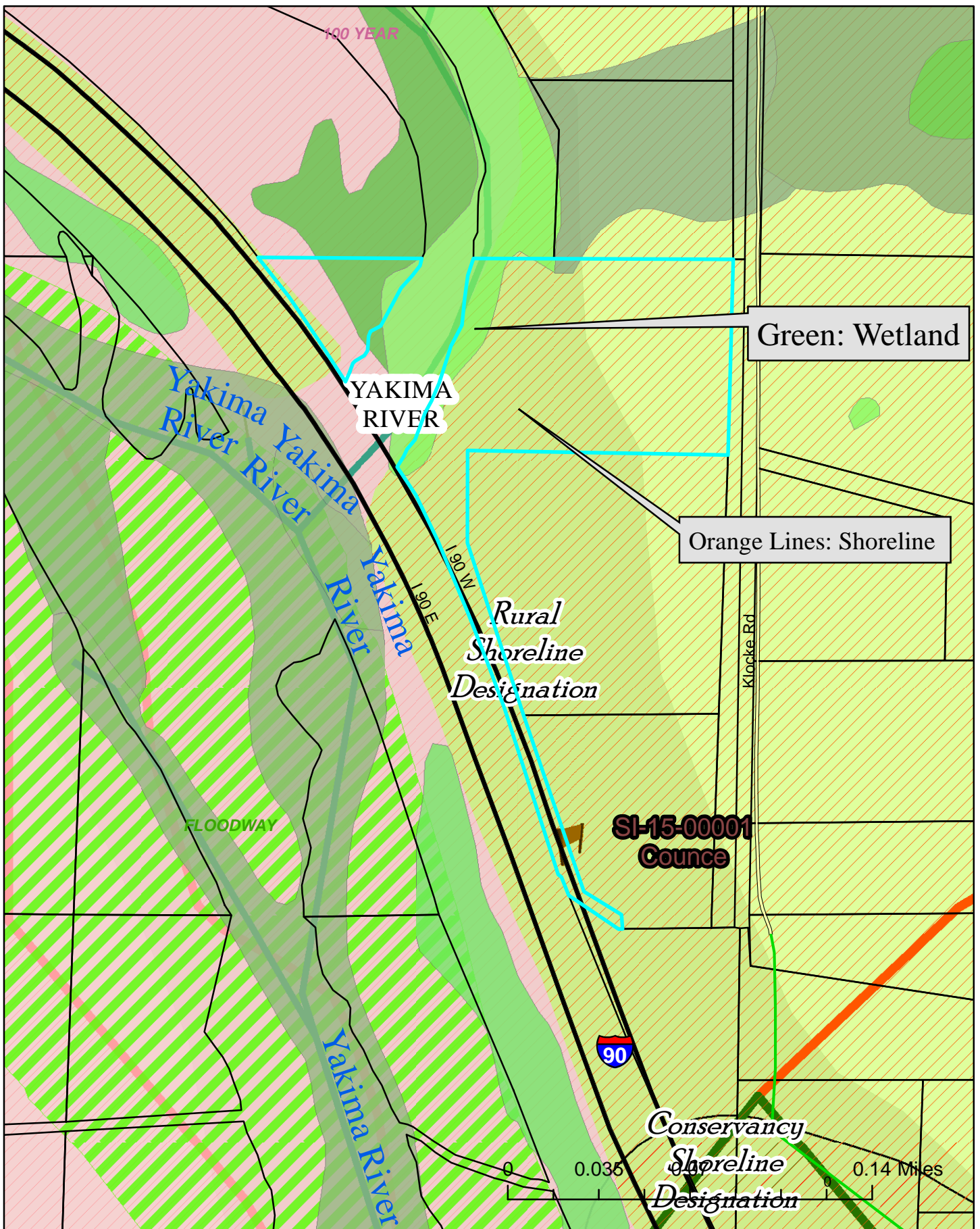

SI-15-00001  
Counce

4/13/2015

Critical Areas  
Map

kaycee.hathaway

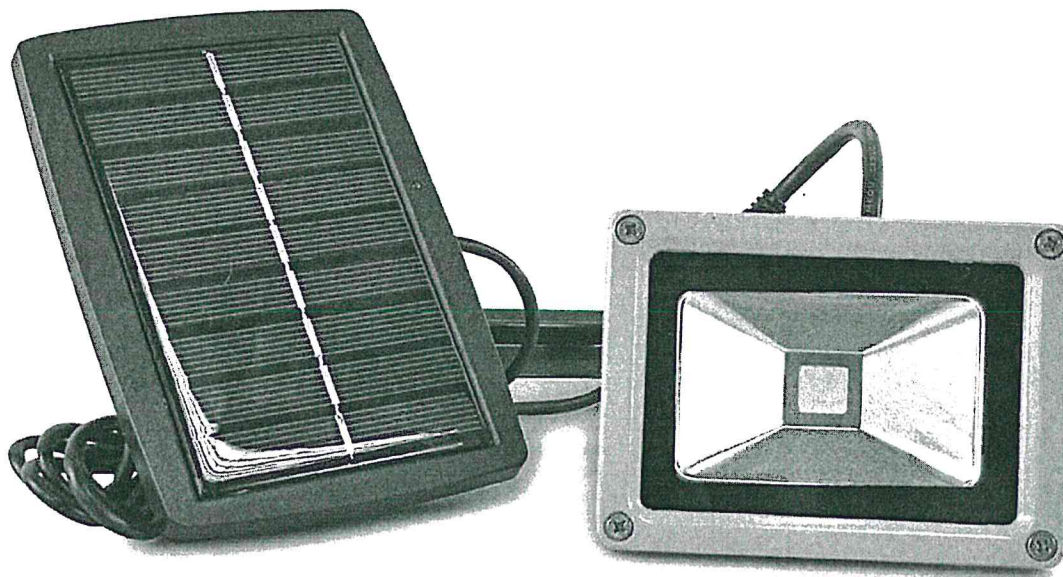

RECEIVED

FEB 2 2015

KITTITAS COUNTY  
CDS



Features:

solar powered, so no electrician is required, no extra wires required

The Perfect Light for Your Outdoor Sign or Flag, You can add these outdoor lights anywhere

1\*10W High Power super-bright LED Chip automatically turn on at dusk charging 6 to 8 hours can work normally on 4-6 hours (sunny weather in the UK), use it all night long!

weatherproof and has an IP44 weather rating, Works Year Round, In All Climates

Specifications:

1. LED type: Solar Power High Power LED spotlight

2. Color: Warm White/ White

3. LED Quantity: 1\*10W High Power LED

6. Power source: solar power

7. Power Source: solar panels 5.5 V / 270 ma 1.5 W, 3XAA Ni-MH 1200 mAh Battery (included)

8. COB Spotlight LM and TC: 900-1000LM White: 2700K-3000K

9. CE Certificate guarantee

10. Warranty: 1 Years

11. Waterproof Grade: IP44

12. Beam angle: 120 degree

RECEIVED

FEB 2 2015

KITTITAS COUNTY  
CDS

One billboard located south east corner of parcel 059433. Height of this sign will be 13 feet and 15 feet wide. This sign will be setback 10 feet from the property line parcel 059433 south east corner.

---

RECEIVED  
FEB 2 2015  
KITITAS COUNTY  
CDS

## Kaycee Hathaway

---

**From:** Kaycee Hathaway  
**Sent:** Wednesday, April 01, 2015 8:31 AM  
**To:** imfbryancounce@msn.com  
**Subject:** SI-15-00001 Counce Additional Information  
**Attachments:** SI-15-00001 Counce Recorded Survey.pdf

Dear Mr. Counce,

I am processing your application and I have found that I need a site plan that shows your complete parcel (i.e. property lines) and the location of your free standing sign with the distances from all property lines. The County's COMPAS mapping system is skewed for your parcel so I found a recorded survey of your parcel which is attached. Could you please indicate upon the attached survey where you are locating your sign and the distances from all property lines please. If you have any additional questions please feel free to contact me.

Thank you and sorry for the delay in the processing of this application.

Kaycee K Hathaway  
Kittitas County  
Community Development Services/ Planner I  
Phone: (509) 962-7079  
Email: [kaycee.hathaway@co.kittitas.wa.us](mailto:kaycee.hathaway@co.kittitas.wa.us)



3098

20061114 0011

# PART OF THE NORTHEAST QUARTER OF SECTION 19, TOWNSHIP 18 NORTH, RANGE 18 EAST, W.M.



### LEGEND

- SET 5/8" REBAR W/ YELLOW CAP - "CRUSE 18078"
- FOUND PIN & CAP
- — — FENCE
- FOUND ENCASED MONUMENT

### GRAPHIC SCALE

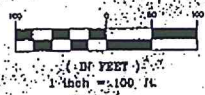

RECEIVED  
APR 20 2015  
KITITAS COUNTY  
CDS

FD 1-1/2" PIPE  
SEE LCR, BK 5  
PAGE 324  
VISITED 7/06

BK 31 OF SURVEYS  
PAGE 181

FD PIN  
S 89°29' E, 3.5'

CALC. NE COR.  
SE 1/4 NE 1/4

### LEGAL DESCRIPTIONS

ORIGINAL PARCELS - AFN 20031100026 &  
AFN 200104050002

### PARCEL A

PARCEL A OF THAT CERTAIN SURVEY AS RECORDED NOVEMBER 14, 2006 IN BOOK 33 OF SURVEYS AT PAGE 118, UNDER AUDITOR'S FILE NO. 20061114, 2011, RECORDS OF KITITAS COUNTY, STATE OF WASHINGTON; BEING A PORTION OF THE NORTHEAST QUARTER OF SECTION 19, TOWNSHIP 18 NORTH, RANGE 18 EAST, W.M., IN THE COUNTY OF KITITAS, STATE OF WASHINGTON.

### PARCEL B

PARCEL B OF THAT CERTAIN SURVEY AS RECORDED NOVEMBER 14, 2006 IN BOOK 33 OF SURVEYS AT PAGE 118, UNDER AUDITOR'S FILE NO. 20061114, 2011, RECORDS OF KITITAS COUNTY, STATE OF WASHINGTON; BEING A PORTION OF THE NORTHEAST QUARTER OF SECTION 19, TOWNSHIP 18 NORTH, RANGE 18 EAST, W.M., IN THE COUNTY OF KITITAS, STATE OF WASHINGTON.

### NOTES:

1. THIS SURVEY WAS PERFORMED USING A NIKON DTM-521 TOTAL STATION, THE CONTROLLING MONUMENTS AND PROPERTY CORNERS SHOWN HEREON WERE LOCATED, STAKED AND CHECKED FROM A CLOSED LINE TRAVERSE IN EXCESS OF 1:10,000 LINEAR CLOSURE AFTER AZIMUTH ADJUSTMENT.
2. THIS SURVEY MAY NOT SHOW ALL EASEMENTS OR IMPROVEMENTS WHICH MAY PERTAIN TO THIS PROPERTY.

110

RECEIVED  
APR 07 2015  
KITITAS COUNTY  
CDS

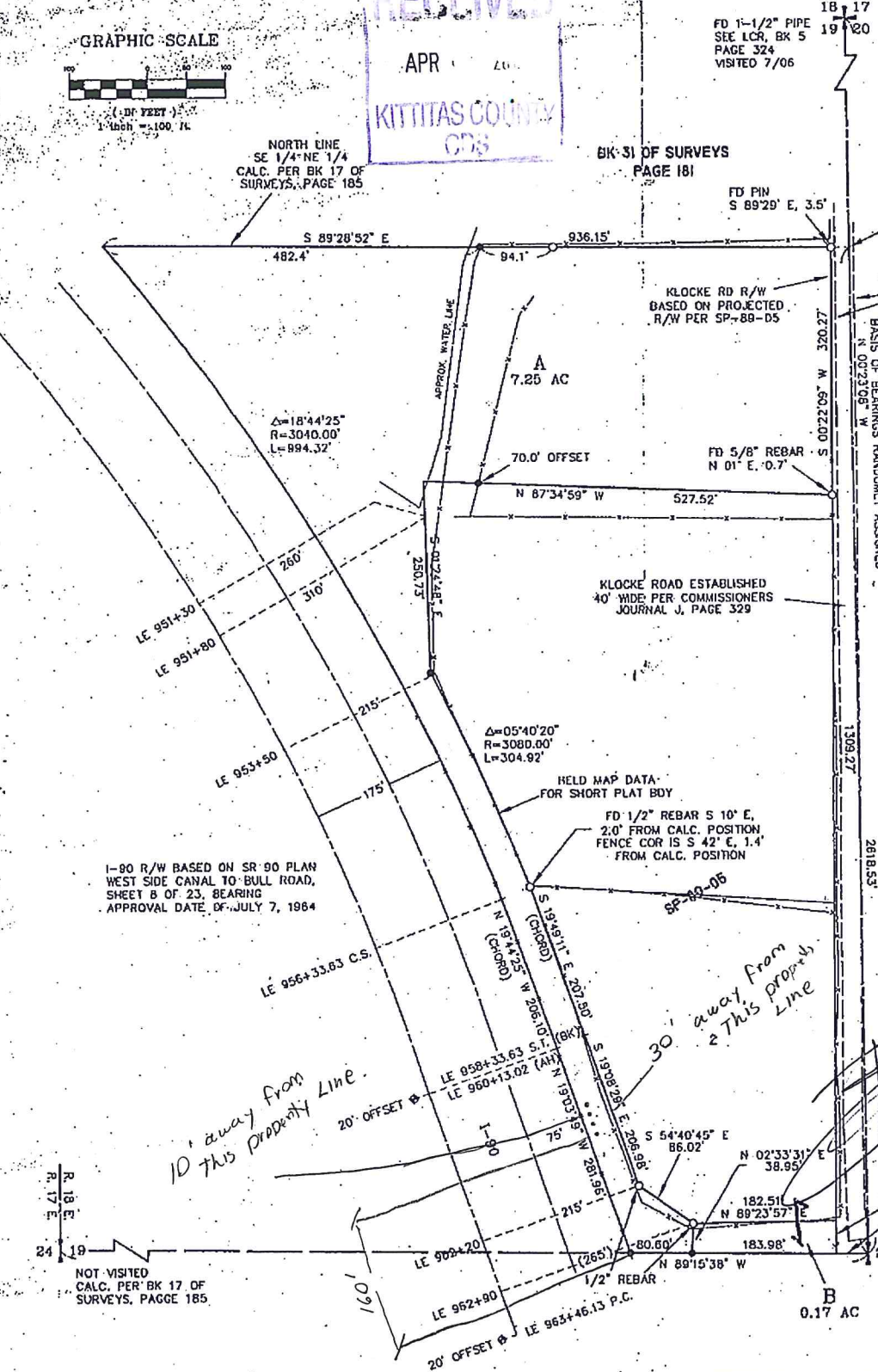
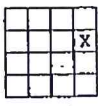

AUDITOR'S CERTIFICATE

Filed for record this 14TH day of NOVEMBER, 2006, at 12:23 P.M., in Book 33 of Surveys at page(s) 118, at the request of Cruse & Associates.

GERALD V. PETTIT, Auditor  
KITITAS COUNTY AUDITOR

SURVEYOR'S CERTIFICATE

This map correctly represents a survey made by me or under my direction in conformance with the requirements of the Survey Recording Act of the request of DONLEE MOORE in JULY of 2006.

Charles A. Cruse, Jr.  
Professional Land Surveyor

NOVEMBER 14, 2006  
DATE  
License No. 18078



CRUSE & ASSOCIATES  
PROFESSIONAL LAND SURVEYORS  
217 East Fourth Street P.O. Box 959  
Ellensburg, WA 98926 (509) 962-8242

MOORE PROPERTY

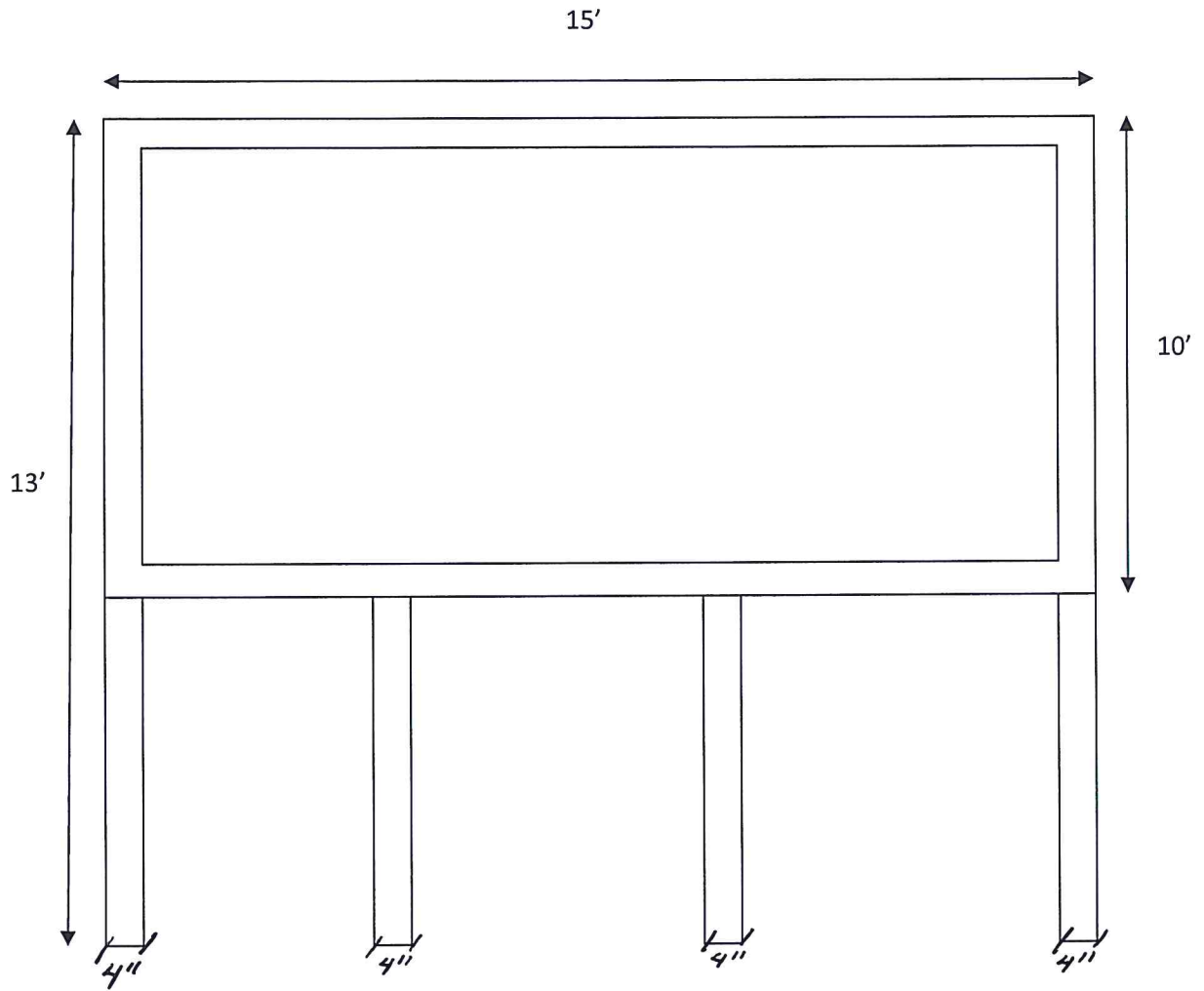

RECEIVED

FEB 2 2015

KITTITAS COUNTY  
CDS



Google

Get directions My places

Washington  
Not your current location? Correct it  
Put your business on Google Maps



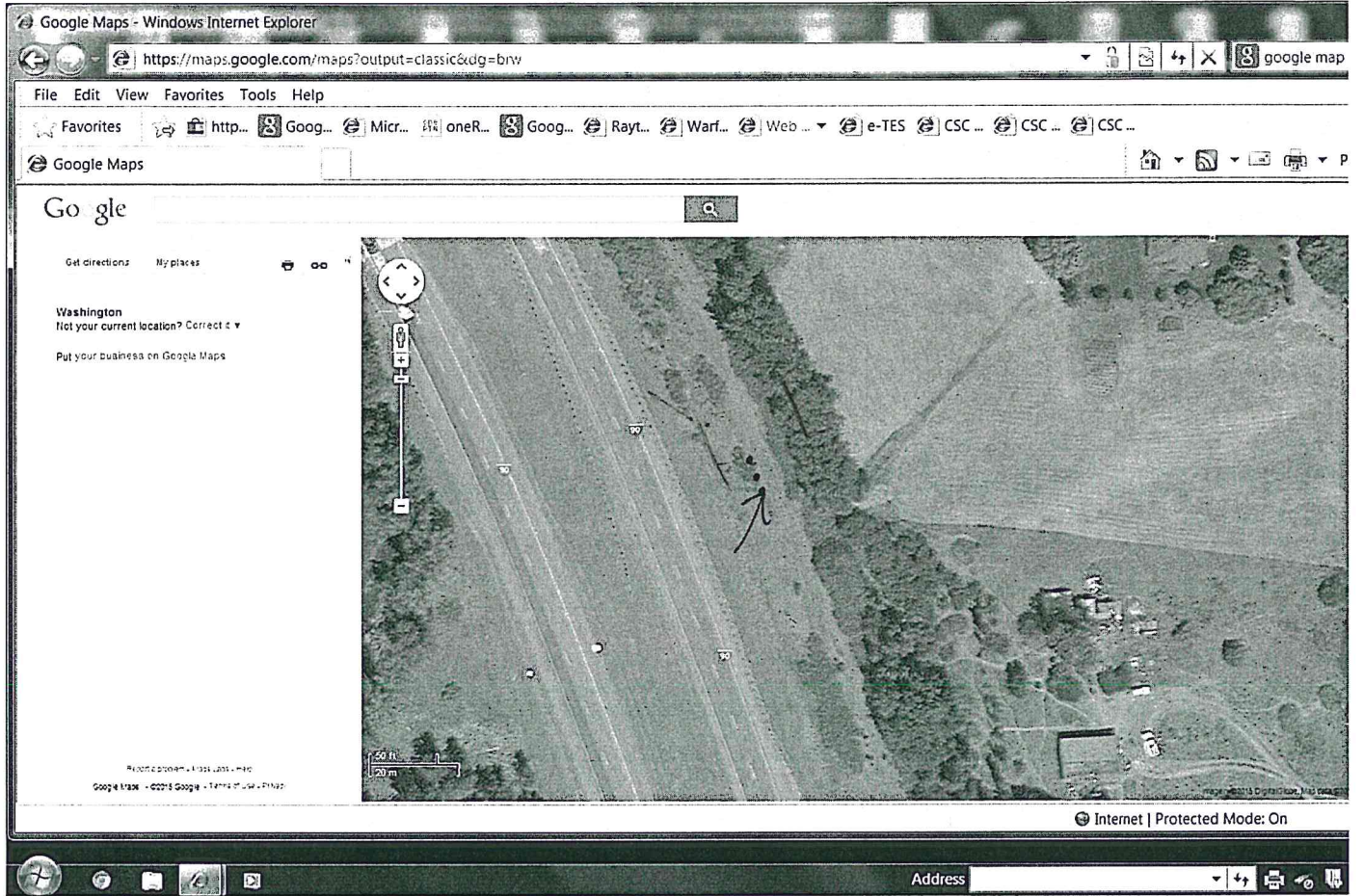

Google



RECEIVED

FEB 2 2015

KITTITAS COUNTY  
CDS



SI-15-00001

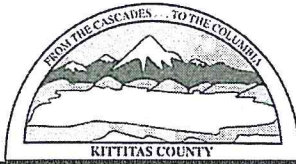

KITTTAS COUNTY COMMUNITY DEVELOPMENT SERVICES

411 N. Ruby St., Suite 2, Ellensburg, WA 98926

CDS@CO.KITTTAS.WA.US

Office (509) 962-7506

Fax (509) 962-7682

"Building Partnerships - Building Communities"

**SIGN PERMIT APPLICATION**

*(For a permit to place a sign on a structure or site in accordance with KCC 17.72)*

Please type or print clearly in ink. Attach additional sheets as necessary. Pursuant to KCC 15A.03.040, a complete application is determined within 28 days of receipt of the application submittal packet and fee. The following items must be attached to the application packet.

**REQUIRED ATTACHMENTS**

- Site Plan showing the location of the sign, all roads and drives, setbacks from property lines, distance from right-of-way edge (Distance from the edge of a right-of-way shall be measured horizontally along a line normal or perpendicular to the center line of the highway).
- Description of proposed sign: include dimensions, height and size of posts or footings, a statement of the precise location where the sign is to be erected or maintained, and a statement of the proposed size and shape of the design. Include a picture/visual of the sign if available.
- Project Narrative responding to Question 9 on the following pages.

RECEIVED

FEB 2 2015







KITTTAS COUNTY  
CDS

**APPLICATION FEES:**

75.00 Kittitas County Community Development Services (KCCDS)

**\$75.00 Total fees due for this application** (One check made payable to KCCDS)

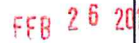
**FOR STAFF USE ONLY**

Application Received By (CDS Staff Signature): 	DATE: 	RECEIPT # 	  
DATE/STAMP IN BOX			

COMMUNITY PLANNING • BUILDING INSPECTION • PLAN REVIEW • ADMINISTRATION • PERMIT SERVICES • CODE ENFORCEMENT

FORM LAST REVISED: 04/21/11

Page 1 of 3



GENERAL APPLICATION INFORMATION

1. **Name, mailing address and day phone of land owner(s) of record:**

*Landowner(s) signature(s) required on application form.*

Name: Bryan Counce  
Mailing Address: 471 Klocke Rd  
City/State/ZIP: Ellensburg WA 98926  
Day Time Phone: 509 - 571-8571  
Email Address: 1mfbryan.counce@msn.com

2. **Name, mailing address and day phone of authorized agent, if different from landowner of record:**

*If an authorized agent is indicated, then the authorized agent's signature is required for application submittal.*

Agent Name: \_\_\_\_\_  
Mailing Address: \_\_\_\_\_  
City/State/ZIP: \_\_\_\_\_  
Day Time Phone: \_\_\_\_\_  
Email Address: \_\_\_\_\_

3. **Name, mailing address and day phone of other contact person**

*If different than land owner or authorized agent.*

Name: \_\_\_\_\_  
Mailing Address: \_\_\_\_\_  
City/State/ZIP: \_\_\_\_\_  
Day Time Phone: \_\_\_\_\_  
Email Address: \_\_\_\_\_

4. **Street address of property:**

Address: \_\_\_\_\_  
City/State/ZIP: \_\_\_\_\_

5. **Legal description of property (attach additional sheets as necessary):**

\_\_\_\_\_  
\_\_\_\_\_

6. **Tax parcel number:** 059433

7. **Property size:** 7.25 (acres)

8. **Land Use Information:**

Zoning: AG 20                      Comp Plan Land Use Designation: Rural working

**PROJECT NARRATIVE**

(INCLUDE RESPONSES AS AN ATTACHMENT TO THIS APPLICATION)

9. **Narrative project description (include as attachment):** Please include at minimum the following information in your description: describe project size, location, water supply, sewage disposal and all qualitative features of the proposal; include every element of the proposal in the description. *include type of sign, height, area, setbacks.*

**AUTHORIZATION**

10. Application is hereby made for permit(s) to authorize the activities described herein. I certify that I am familiar with the information contained in this application, and that to the best of my knowledge and belief such information is true, complete, and accurate. I further certify that I possess the authority to undertake the proposed activities. I hereby grant to the agencies to which this application is made, the right to enter the above-described location to inspect the proposed and or completed work.

All correspondence and notices will be transmitted to the Land Owner of Record and copies sent to the authorized agent or contact person, as applicable.

Signature of Authorized Agent:  
(REQUIRED if indicated on application)

Date:

X \_\_\_\_\_

\_\_\_\_\_

Signature of Land Owner of Record  
(Required for application submittal):

Date:

X  \_\_\_\_\_

Feb-26-15

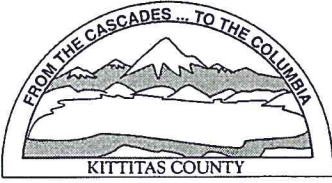

KITTITAS COUNTY PERMIT CENTER  
411 N. RUBY STREET, ELLENSBURG, WA 98926

**RECEIPT NO.:** 00024469

COMMUNITY DEVELOPMENT SERVICES  
(509) 962-7506

PUBLIC HEALTH DEPARTMENT  
(509) 962-7698

DEPARTMENT OF PUBLIC WORKS  
(509) 962-7523

**Account name:** 029602

**Date:** 2/26/2015

**Applicant:** BRYAN COUNCE

**Type:** cash

<u>Permit Number</u>	<u>Fee Description</u>	<u>Amount</u>
SI-15-00001	SIGN PERMIT FEE	75.00
	Total:	75.00

# PART OF THE NORTHEAST QUARTER OF SECTION 19, TOWNSHIP 18 NORTH, RANGE 18 EAST, W.M.



### GRAPHIC SCALE

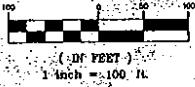

FD 1-1/2" PIPE  
SEE LCR, BK 5  
PAGE 324  
VISITED 7/06

### LEGEND

- SET 5/8" REBAR W/ YELLOW CAP - "CRUSE 18078"
- FOUND PIN & CAP
- x — FENCE
- ⊙ — FOUND ENCASED MONUMENT

BK 31 OF SURVEYS  
PAGE 181

NORTH LINE  
SE 1/4 NE 1/4  
CALC. PER BK 17 OF  
SURVEYS, PAGE 185

FD PIN  
S 89°29' E, 3.5'

CALC. NE COR  
SE 1/4 NE 1/4

EXISTING RD

### LEGAL DESCRIPTIONS

ORIGINAL PARCELS - AFN 200311100026 &  
AFN 200104050002

### PARCEL A

PARCEL A OF THAT CERTAIN SURVEY AS RECORDED  
NOVEMBER 14, 2006 IN BOOK 33 OF SURVEYS AT  
PAGE 118, UNDER AUDITOR'S FILE NO.  
20061114 0011, RECORDS OF KITTITAS COUNTY,  
STATE OF WASHINGTON; BEING A PORTION OF THE  
NORTHEAST QUARTER OF SECTION 19, TOWNSHIP 18  
NORTH, RANGE 18 EAST, W.M., IN THE COUNTY OF  
KITTITAS, STATE OF WASHINGTON.

### PARCEL B

PARCEL B OF THAT CERTAIN SURVEY AS RECORDED  
NOVEMBER 14, 2006 IN BOOK 33 OF SURVEYS AT  
PAGE 118, UNDER AUDITOR'S FILE NO.  
20061114 0011, RECORDS OF KITTITAS COUNTY,  
STATE OF WASHINGTON; BEING A PORTION OF THE  
NORTHEAST QUARTER OF SECTION 19, TOWNSHIP 18  
NORTH, RANGE 18 EAST, W.M., IN THE COUNTY OF  
KITTITAS, STATE OF WASHINGTON.

### NOTES:

1. THIS SURVEY WAS PERFORMED USING A NIKON DTM-521 TOTAL STATION. THE CONTROLLING MONUMENTS AND PROPERTY CORNERS SHOWN HEREON WERE LOCATED, STAKED AND CHECKED FROM A CLOSED FIELD TRAVERSE IN EXCESS OF 1:10,000 LINEAR CLOSURE AFTER AZIMUTH ADJUSTMENT.
2. THIS SURVEY MAY NOT SHOW ALL EASEMENTS OR IMPROVEMENTS WHICH MAY PERTAIN TO THIS PROPERTY.

1-90 R/W BASED ON SR 90 PLAN  
WEST SIDE CANAL TO BULL ROAD,  
SHEET 8 OF 23, BEARING  
APPROVAL DATE OF JULY 7, 1984

KLOCKE ROAD ESTABLISHED  
40' WIDE PER COMMISSIONERS  
JOURNAL J, PAGE 329

HELD MAP DATA  
FOR SHORT PLAT BOY

FD 1/2" REBAR S 10° E,  
2.0' FROM CALC. POSITION  
FENCE COR IS S 42° E, 1.4'  
FROM CALC. POSITION

BASIS OF BEARINGS RANDOMLY ASSIGNED

R. 18 E  
R. 17 E

NOT VISITED  
CALC. PER BK 17 OF  
SURVEYS, PAGE 185

FD ENC MON  
VISITED 7/06

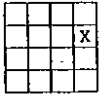

### AUDITOR'S CERTIFICATE

Filed for record this 14TH day of NOVEMBER,  
2006, at 12:23 P. M., in Book 33 of Surveys at  
page(s) 118 of the request of Cruse & Associates.

JERALD V. PETTIBOND  
KITTITAS COUNTY AUDITOR

### SURVEYOR'S CERTIFICATE

This map correctly represents a survey made by me or  
under my direction in conformance with the requirements  
of the Survey Recording Act of the request of  
DONLEE MOORE in JULY of 2006.

Charles A. Cruse, Jr.  
CHARLES A. CRUSE, JR.  
Professional Land Surveyor

NOVEMBER 14, 2006  
DATE  
License No. 18078

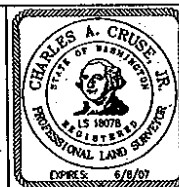

**CRUSE & ASSOCIATES**  
PROFESSIONAL LAND SURVEYORS  
217 East Fourth Street P.O. Box 959  
Ellensburg, WA 98926 (509) 962-8242

**MOORE PROPERTY**

In re: Bangs Boundary Line Adjustment, BLA-07-150

**NEW LEGAL DESCRIPTION AFTER BOUNDARY LINE ADJUSTMENT**

Lot 2 as delineated on Short Plat No. 79-05 recorded under Auditor's File No. 437257, being a portion of the Southeast quarter of the Northeast quarter of Section 19, Township 18 North, Range 18 East, W.M., as recorded in Book A of Short Plats, pages 64 and 65, records of Kittitas County, State of Washington.

Together with: Parcel B of that certain survey as recorded November 14, 2006 in book 33 of surveys at page 118, under Auditor's File No. 200611140011, records of Kittitas County, State of Washington; being a portion of the Northeast quarter of Section 19, Township 18 North, Range 18 East, W.M., in the County of Kittitas, State of Washington.